

D1

3 BED / 2.5 BATH

1688

SQ. FT.

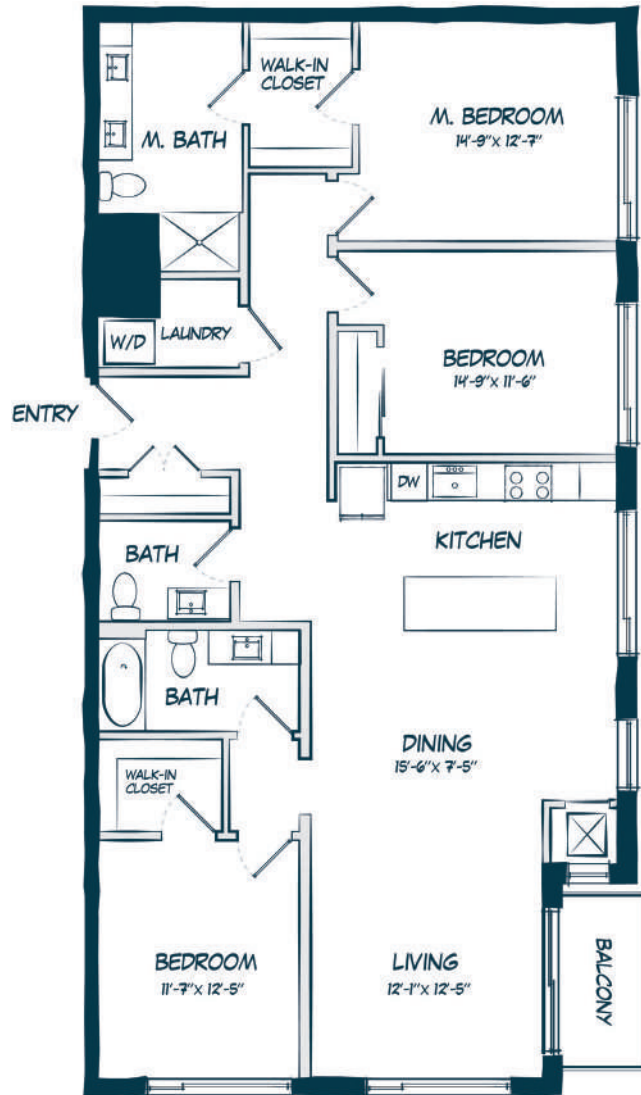

CARAWAY
WEST END

5235 Wayzata Blvd. | St Louis Park, MN 55416

www.carawaywestend.com

* Pricing and availability are subject to change. Rent is based on monthly frequency. Additional fees may apply, such as but not limited to package delivery, trash, water, amenities, etc.

** Floorplans are artist's rendering. All dimensions are approximate. Actual product and specifications may vary in dimension or detail. Not all features are available in every apartment. Please see a representative for details.